

MANUAL

ROUND WAX EXTRACTOR BASED ON A STAINLESS-STEEL SETTLER 100-200L. + GAS BURNER



LYSON

Przedsiębiorstwo Pszczelarskie Łysoń

Spółka z o.o.

34-124 Klecza Górna, st.Pszczela 2, Poland

www.lyson.eu, e-mail; lyson@lyson.com.pl

Tel. +48 33/875-99-40, +48 33/870-64-02

The following manual encompasses the devices bearing the following coding:

W4096P, W4097P + gas burner
W4096P_BP, W4097P_BP-without gas burner

Manual

1. General safety principles for wax extractors with a gas burner
 - 1.1. Operating safety
 2. Operating a gas burner
 - 2.1. Burner assembly
 - 2.2. Disconnecting the cylinder from the burner
 - 2.3. Device activation
 - 2.4. Device deactivation
 3. Periodical checks
 4. Operational description for the wax extractor with a gas burner
 5. Characteristics of the wax extracting devices with a gas burner
 - 5.1. Device for wax extraction
 - 5.2. Device diagram
 6. Cleaning and maintenance
 7. Recycling
 8. Guarantee

STAINLESS STEEL WAX EXTRACTORS WITH GAS BURNER (PROPANE-BUTANE)

1. General safety principles for wax extractors with a gas burner

Prior to operating the device please refer to the manual and act according to the guidelines contained therein. The manufacturer cannot be held accountable for the damages cause by misusing the device or its improper handling



1.1. Operating safety

1. The following equipment is not intended to be used by persons with limited physical, sensory or mental capabilities (including children) or persons inexperienced or unfamiliar with that type of equipment unless the usage occurs under supervision or in line with the equipment operating manual provided by safety supervising persons. Prevent children from playing with the extractor.
2. In case of damage and in order to avoid the threat, the repairs must be performed by a specialised servicing centre or by an authorised person.
3. It is forbidden to make any maintenance works while device is under operation.
4. In case of any threat, disconnect the gas cylinder immediately and remove it from the device. The extractor may be restarted once the threat has been eliminated.



- In case when the aforementioned warning has been ignored and the installation has been completed by a person without the relevant qualifications, there is a threat of device damaging, damage to property, fire, explosion, suffocation or sustaining other injuries that may result in permanent disability
- Once the installation has been terminated, the tightness of all connections must be checked by means of a leak tester (electronic or soap suds). *Never use fire to test the tightness!*

2. OPERATING A GAS BURNER

2.1. BURNER ASSEMBLY

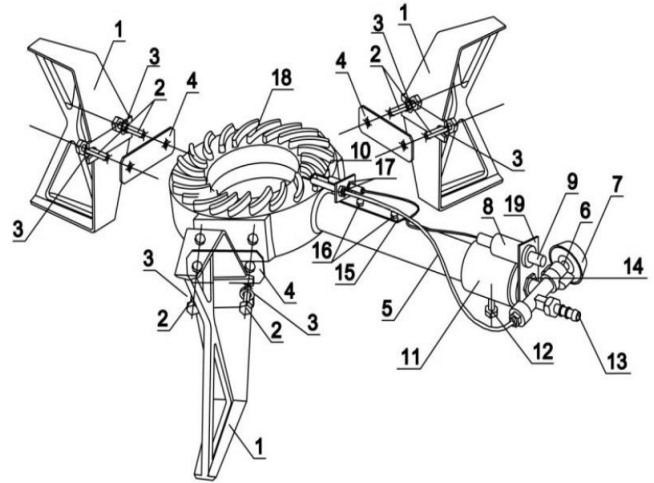

1. Legs
2. Leg fixing bolts
3. Washers for leg fixing bolts
4. Gasket for leg fixing
5. Thermocouple wire
6. Valve with thermoelectric protection
7. Valve knob
8. Piezoelectric lighter
9. Piezoelectric fighter button
10. Igniting electrode
11. Air supply regulating band
12. The bolt to tighten the band
13. Connecting spigot
14. Valve controlling nut
15. Support to fix the fighter and thermocouple wire
16. Bolts to fix the igniting electrode and thermocouple wire
17. Nuts to fix the igniting electrode and thermocouple wire
18. Cast-iron burner
19. A support to fix the piezoelectric lighter
20. Controlling spigot

2.2. CONNECTING THE CYLINDER TO THE BURNER

- (A). Gas cylinder ought to be placed vertically at least 1.5 m away from the device.
- (B). Certified gas hose for propane-butane (item 3) ought to be placed on the connecting spigot (item 1) and the spigot of the gas reducer.
- (C). Check whether the hose is of proper diameter.
- (D). Make sure that the hose is fixed tightly.
- (E). Next, place the hose ties (item 2) in order to fix the hose to the connecting spigot and the gas reducer spigot, tighten with a screwdriver or a wrench
- (F). After installation perform the tightness test by using the water with soapy water or an electronic testing device.

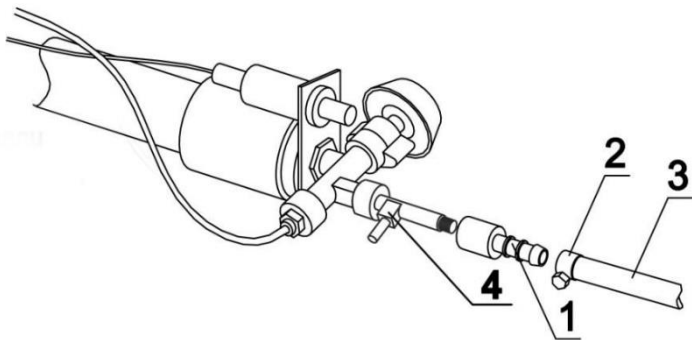

PROPANE BUTANE

1. Connecting spigot Ø 10 mm
2. hose ties
3. Certified gas hose for propane-butane
4. Spigot to check the pressure

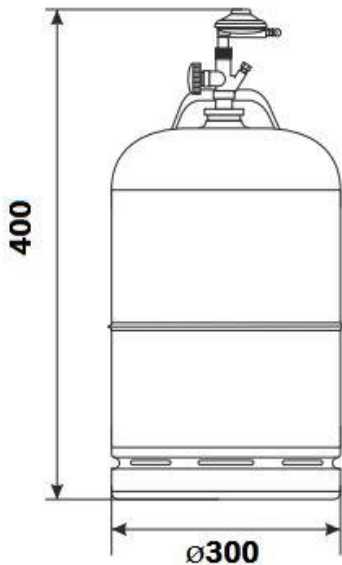
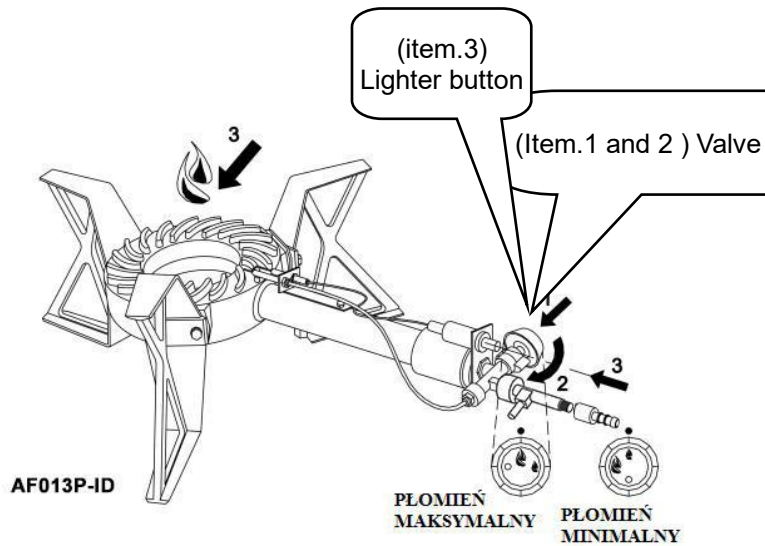

2.4. DEVICE DEACTIVATION

After operations, turn the valve into position „●” – see the drawing below

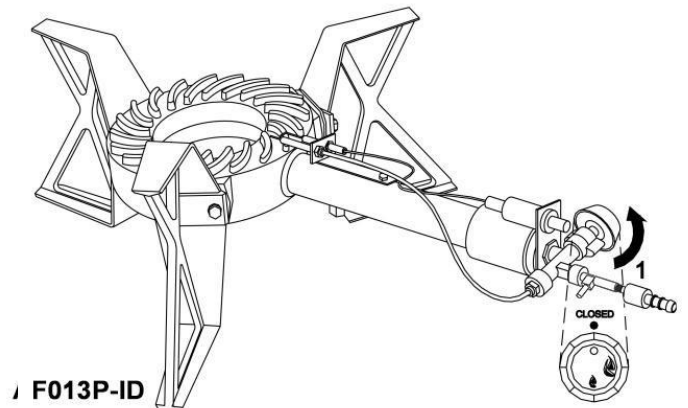

Assembly manner for propane-butane reducer

Due to high power of the device, any operations with a valve, e.g. reducing, increasing, closing the gas supply, ought to be performed slowly. Otherwise, the flame may retract to the nozzle. If that has occurred, gas supply must be closed immediately. The burner is to be restarted after 2 minutes.

2.3. DEVICE ACTIVATION

Once the burner has been properly connected to the cylinder, the following actions must be performed:

Press the valve knob, turn slowly anticlockwise by approximately $\frac{1}{4}$ of a turn (item 2). Ignite the gas with the piezoelectric lighter by pressing the lighter button (item 3) while still pressing the valve knob. After ignition, wait for 30 seconds for the thermocouple wire to operate, next release the knob and regulate the flame to the required size.

REGULACJA DOPŁYWU POWIETRZA

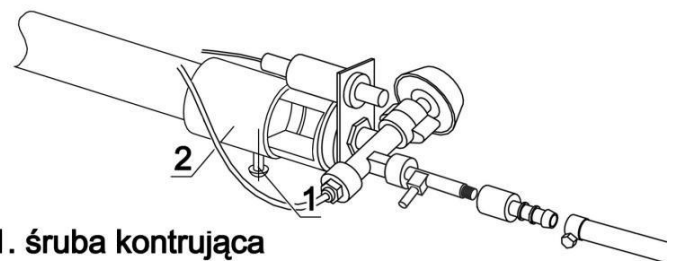

1. śruba kontrolująca
2. opaska regulująca dopływ powietrza

1. Release the lock bolt (item 1).
2. Slowly displace the tie (item 2) and set the primary air supply in order to reach a blue flame (yellow or red flame indicates wrong setting)
3. Slowly tighten the lock bolt (item. 1).

4. After gas cylinder replacement, primary air supply must be regulated. .

Properly performed regulation ought to secure: quick and proper burner ignition, re-ignition and mild flame transfer, non-explosive dispersion of flame in all flame holes in the time below 5 seconds, slight lift-off of the flame is permissible, however after 1 second the flame ought to be stable, should not tend to extinguish nor retract to the nozzle within the entire spectrum of power regulation and while turning the valve knob from maximum to minimum power position (normal speed of turning the valve knob from the maximum to the minimum position lasts approximately 1 s)

WARNING! After usage, the device must always be cleaned. Prior to cleaning, make sure that the gas stool has cooled down – there is a risk of burns. Close the gas supply by tightening the taps. When the device is to be rotated while cleaning, disconnect the gas supplying hose

- (A). Prior to the maintenance, switch the device off and disconnect the gas supply hose.
- (B). Make sure the device has cooled down.
- (C). In order to prevent the device surface, clean it regularly.
- (D). Fat or food residues inside the device may cause a fire.
- (E). Clean the device with a wet cloth.
- (F). Apply the neutral cleaning agents only. The stool cannot be cleaned with abrasive agents, containing corrosive substances, bleaches or acids, avoid using acidic or alkaline substances (lemon juice, vinegar, etc.)
- (G). Do not clean the device with steam cleaners,
- (H). When cleaned, the device must be dried.

3. PERIODICAL CHECKS

Once the guarantee period has terminated, the device ought to be inspected at least once a year. Periodical checks must be performed by the persons qualified for repairs and maintenance of gas devices. The minimum range of the periodical check must include checking for proper operation, maintenance of the gas valves and gas tightness test. Periodical checks are not included into the costs of purchasing the device when performed outside the guarantee period.

Properly prepared burner with the reducer for connection to the gas cylinder.

4. DESCRIPTION OF OPERATION FOR WAX EXTRACTOR WITH A GAS BURNER

1. Fill the tank up with water until the level of a discharge pipe, as in a photo (Photo 1). Refill, when



- needed (take special care not to get burnt)
2. Fill the basket with frames or dried honey.
3. Cover with a lid.
4. Place the burner under the device in such a way to make it possible for the flame to heat the entire bottom of the device.
5. Wait until steam has been created and the extracted wax has drained.
6. After extraction, check the water level and refill if needed.
7. Add new frames or dried honey.
8. Repeat the steps 6 and 7 until extraction stops.
9. **Once the process has terminated, deactivate the burner and close the gas cylinder.**
10. Clean the basket of the honey remains and prepare for reuse.
11. The following device is not intended to be used by persons with limited physical, sensory or mental capabilities (including children) or persons inexperienced or unfamiliar with that type of equipment unless the usage occurs under supervision or in line with the equipment operating manual provided by safety supervising persons.
12. Water is to be refilled through an inlet as in Photo 1.



Photo.1.

Water level is to be refilled until the inlet level (pipe)
Water to be refilled while the device is in operation.
Use funnel to pour through an inspection hole not to lose the heat inside the extractor and to avoid burns with hot steam.

5. Characteristics of the honey extractor

The device is intended to extract wax from the bee frames or to extract dried honey by means of a steam-based method. It consists of an external tank, in which water is stored, and a basket holding the frames or dried honey. Additional equipment includes the gas stool which heats the water tank and generates the steam.

5.1. Wax extractor



Photo.2.

Device parameters:

- material – stainless steel
- steel plate thickness 0.8 mm ; 0.6 mm
- discharge 5/4"

Tank dimensions:

- 100L.-diameter 500mm , height 610mm.
- 200L.-diameter 600mm , height 730mm.

Frame basket dimensions:

- 100L.-diameter 450mm , height.420mm.
- 200L.-diameter 550mm , height.540mm.

Additional equipment:

- Gas stool , power 6,4Kw with thermocouple
- Power supply – propane-butane

The set does not include the reducer for a gas cylinder

Basket capacity:

- Extractor basket 100L.- 65 liters
- Extractor basket 200L.- 125 liters



Photo .3.

5.2. Wax extractor diagram

Legend:

1. lid
2. wax discharge pipe 5/4"
3. gas burner
4. extractor tank
5. water level pipe
6. perforated basket for frames or dried honey
7. basket base
8. wax tub

6. Cleaning and maintenance

Prior to every season, perform an additional technical inspection . In case when a fault is detected, contact a service point.

After use, the wax extractor must be washed with hot water containing a slight amount of detergents admitted to come into contact with food or by means of a steam cleaner.

7. Recycling

Worn-out product must be removed as waste only within selective waste collection organised by the Network of Communal Electric and Electronic Waste Collecting Points.

A customer is entitled to return the used equipment to the electrical equipment distributor network, at least free of charge and directly, if the device to be returned is of proper type and serves the same purpose as the newly purchased device

8. Guarantee

Products purchased from “Łyson” company are encompassed by the manufacturer’s guarantee.

The guarantee duration equals 24 months

A receipt or a VAT invoice is issued for each product purchased

Details on the guarantee, see www.lyson.com.pl