

INSTRUCTIONS MANUAL

Uncapping table with wax extruder 50, 100 kg



LYSON  N

Przedsiębiorstwo Pszczelarskie Łyson

Spółka z o.o.

34-124 Klecza Górna, st.Pszczela 2, Poland

www.lyson.eu, e-mail; lyson@lyson.com.pl

Tel. +48 33/875-99-40, +48 33/870-64-02

INSTRUCTIONS MANUAL

The manual covers following devices (codes):

**Power supply
230V:**

W20984, W20980

Table of contents

1. General safety instructions
 - 1.1. Electrical safety
 - 1.2. Operation safety
2. Product description
 - 2.1. Wax extruder
 - 2.2. Diagram
 - 2.3. Technical specifications
3. Instructions for use
4. Controller
 - 4.1. Buttons and functions
 - 4.2. Setting up
 - 4.3. Error codes
5. Storage
6. Maintenance and cleaning
7. Waste disposal and environmental protection
8. Warranty

Uncapping table with wax extruder 50, 100 kg. Power supply 230V

Before first use read the manual carefully and follow the instructions contained therein. The manufacturer is not liable for damage caused by equipment used inappropriately or by incorrect handling.

1. General safety instructions

1.1. Electrical safety



- Connect the device to a grounded socket with voltage specified on the rating plate of the product.
- The electrical supply system must be fitted with a residual-current circuit breaker with rated tripping current not higher than 30mA. Performance of the circuit breaker should be checked periodically.
- Periodically check the condition of the power cord. Replace the power cord if damaged. Replacing the power cord can only be performed by the manufacturer or by qualified personnel.
Do not use the device if the power cord is damaged!
- In the event of damage to the device, to avoid any health and safety risks, repairs should be carried out only by qualified personnel.
- Do not pull the power cord.
Keep the power cord away from heat sources and sharp edges to ensure its good condition.

1.2. Operation safety

- The device is not intended for use by persons (including children) with limited physical, sensory or mental abilities, or by inexperienced users, unless under supervision or with instructions given by an accountable party.
- The surface on which the unit stands should be dry!
- The "EMERGENCY STOP" button must not be pressed (it must be turned so that it pops out) before working on the appliance.
- By pressing the "Emergency STOP" button, the extruder can be stopped immediately.
- The grating protecting the feed hopper should be closed when the extruder is running!
- Do not move the device during operation.
- Protect the motor and the control unit against moisture (also during storage).
- Do not use the device near flammable materials.
- Never carry out any maintenance or repairs during operation or if the device is plugged in!

- All covers must be firmly attached to the device during operation
- In case of any danger, use the safety switch immediately. The device can be restarted after the hazard has been eliminated.
- For indoor use only. The device is not suitable for outdoor use.



Never carry out any repairs during operation



2. Product description

2.1. Uncapping table with wax extruder

The device is designed for uncapping frames and separating honey from uncapped wax in mechanically. This process takes place inside a perforated cylinder, where the rotating separating-pressing screw presses out the honey, which escapes through holes between the separating shaft and the perforated plate and drips onto a sieve below, while the remaining wax is is moved and pressed by the screw and then ejected outside. The dry wax is thus obtained in a form ready for melting.

2.2. Diagram

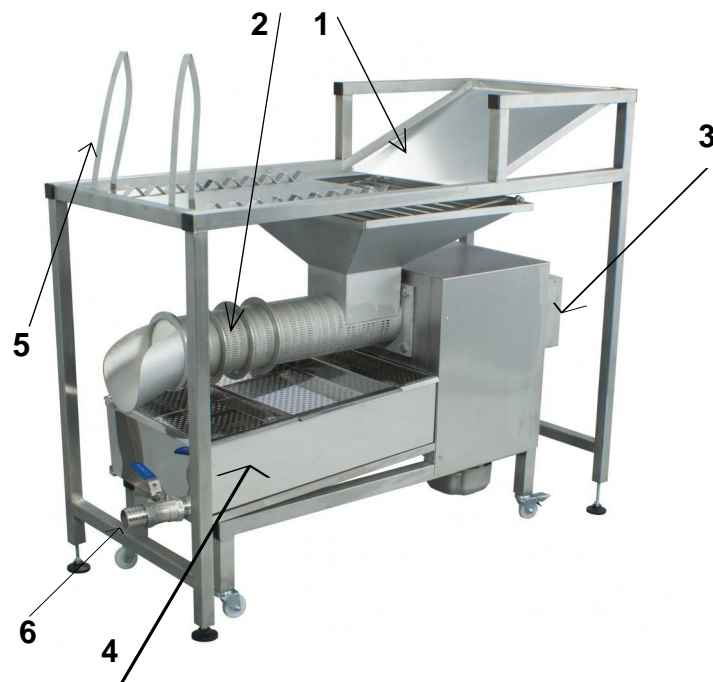

Elements:

1. feed hopper
2. pressing screw
3. controller
4. Honey tray with sieves
5. Frame support
6. drain valve

2.3. Technical specifications:

- Made of stainless, acid-resistant steel
- Power supply – 230 V
- Ball valve 5/4"

a) extruder 50kg: -rated power 0,55kW
-max rpm: 14
-weight 45kg
-dimensions:
-h.680x w.410x l.1050 mm

b) extruder 100kg: -rated power 0,55kW
-max rpm: 9
-weight 82kg
-dimensions:
h.800x w.520x l.1280 mm

3. Instructions for use

Ensure that the control is switched off before switching the unit on.

The switch (0/1) on the control panel should be in position "0"
After the device is switched on to the mains Switch (0/1) on the control panel is switched from position "0" to position "1"
Start the extruder by pressing button 1 (rotation right) or button 3 (rotation left). Button 2 (STOP) is used to stop the extruder.

WARNING!!!

When refilling the feed hopper, care must be taken to ensure that no hard elements (stone, metal parts) enter the extruder and damage the perforated cylinder.

4. Controller

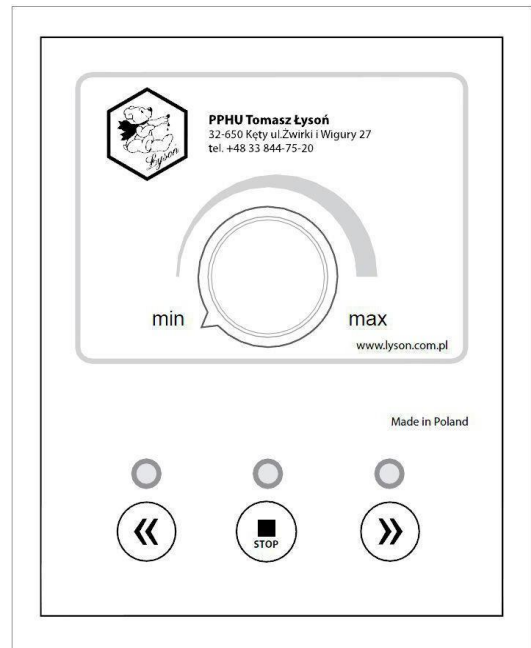

The operation of the controller is down to switching on the extruder motor by pressing button 1 to the right or 3 to the left with the user-specified revolutions set by knob 7.

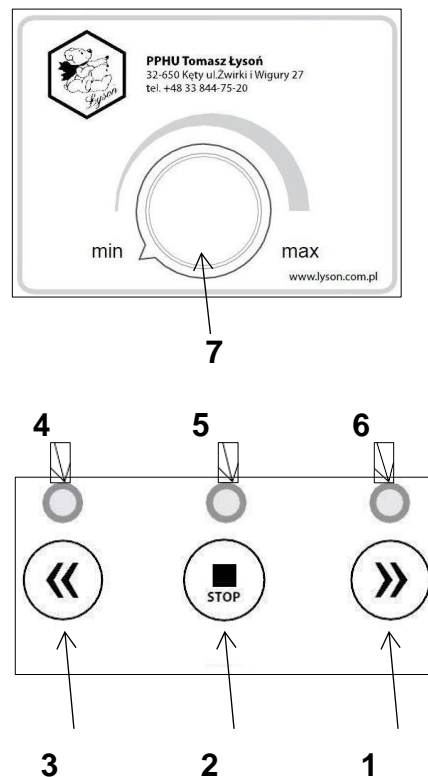

4.1. Buttons and functions

Element	Function
1	START RIGHT button. Pressing the button will start the extruder in continuous operation. To stop the cycle, press the STOP button (2).
2	STOP button. Pressing the button puts the controller into stop mode.
3	LEFT START button. Pressing the button will start the extruder in continuous operation. To stop the cycle, press the STOP button (2).
4	LED indicating extruder operation - left rotation
5	LED indicating the stop status of the device. Blinking of the diode indicates safety loop activation status.
6	LED indicating extruder operation – right rotation
7	Speed control knob (speed setting from 0 - max). Setting the speed to 0 does not switch the unit off

4.2. Setting up

After switching on the power, the controller performs a start-up sequence - carrying out several basic diagnostic tests to confirm correct operation of the device. Detection of errors is signalled by the blinking of LED 4 and lighting of the appropriate combination of LEDs 5 and 6. If no errors are detected, the controller will go into the stop state - waiting for user commands.

Operation of the controller is limited to starting the extruder by pressing button 1 or 3. The **STOP** button makes it possible to stop the extruder operation and shut down the work in progress. The cycle will restart when button 1 or 3 is pressed. Detection of a safety loop tripping condition (pressing the emergency **STOP** button) will immediately switch off the motor rotation and stop the extruder.

Release of the safety loop (turning the **STOP** button to the right) means a return to the operational state.

4.3. Error codes

The controller is equipped with diagnostic procedures - increasing safety and comfort of operation.

Error signalling

- errors are signalled by the appropriate combination of LEDs 4, 5, 6
- detection of error causes immediate stop of the extruder
- restart of the controller is possible after: switching off the power supply, removing the fault and switching on the power supply of the system again
- switching off the power supply of the controller clears the error memory

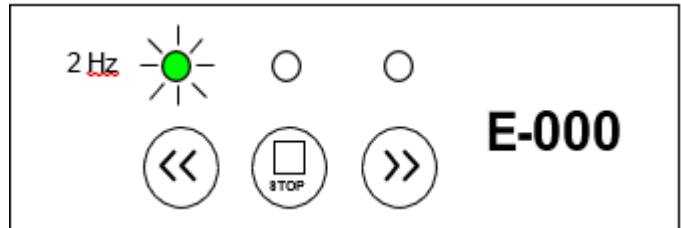

INTERNAL FAULT OF
MICROPROCESSOR CONTROLLER

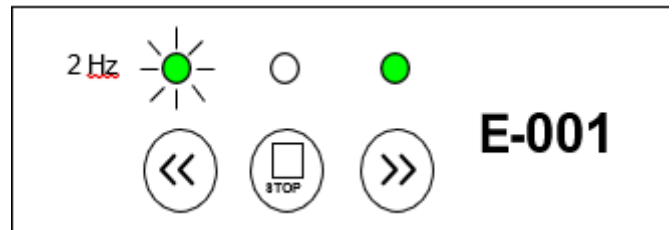

PRESSED / FAULTY START BUTTON
DIRECTION – LEFT

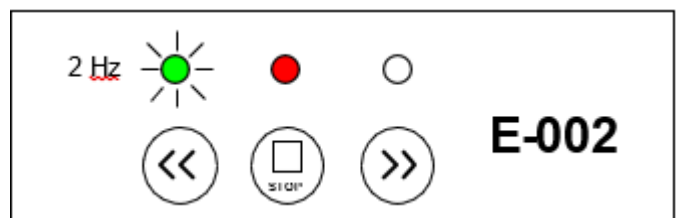

PRESSED / FAULTY STOP BUTTON

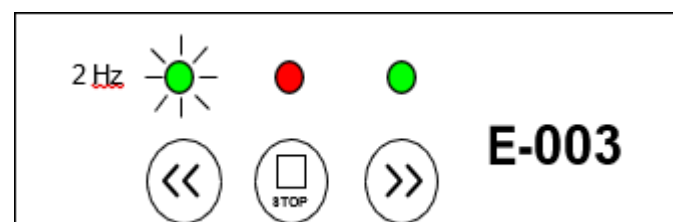

PRESSED / FAULTY START BUTTON DIRECTION -
RIGHT

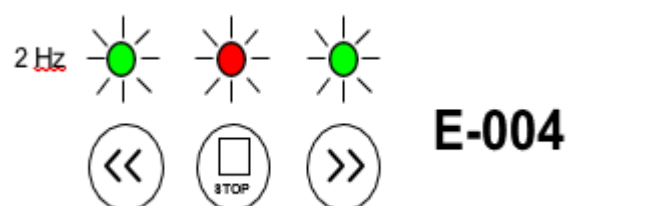

EMERGENCY LOOP FAULT - EMERGENCY
BUTTON PRESSED

5. Storage

Clean and dry the unit thoroughly after use.

If the device has been moved from a cold room to a room with a higher temperature, before switching on wait until it reaches the ambient temperature and all condensation water evaporates.

Store the device in a dry and frost-free room.

An additional technical check should be carried out periodically, and if any defects are found, please contact the manufacturer.

6. Maintenance and cleaning



IMPORTANT!

Unplug the device before commencing any maintenance or cleaning procedures!

Before first use the equipment must be thoroughly cleaned and dried.

Clean with hot water using detergents allowed in food industry using a soft cloth.

After cleaning rinse the device and allow it to dry thoroughly.

Store the device in a dry room.

Do not use any chemical agents to protect the devices elements.

In order to thoroughly wash the extruder after the end of the season, it is recommended to remove the perforated element together with the feed hopper. To do this, unscrew the four screws fixing this element's flange to the frame.

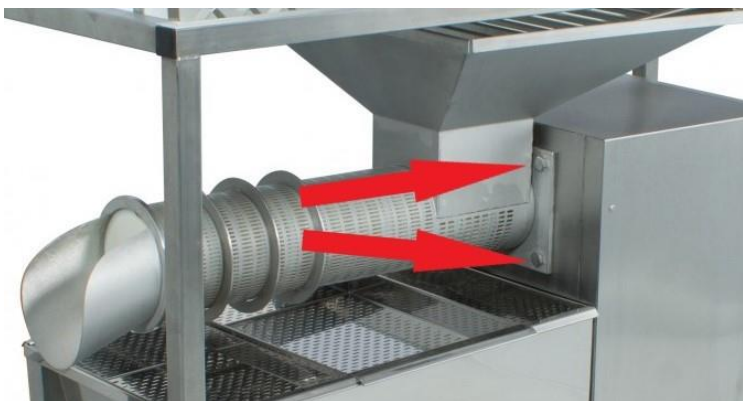

7. Waste disposal and environmental protection

The used product must be disposed in accordance with the local regulations. Return the device to a collection point from where it can be submitted for environmentally compatible recycling.

The consumer has the right to return used equipment directly to the manufacturer's distribution network, free of charge, while replacing it with a new unit as long as the used device is of the same kind and same application as the newly purchased device.

8. Warranty

The product purchased from the Lyson Company is covered by a manufacturer's warranty. The warranty period is 24 months from the date of purchase.

All purchased products come with receipts or VAT invoices.

Warranty details at:

www.lyson.com.pl

